

Industrialising the production of large offshore fish farms

by
Heidi Baugstø
Chairman, Ocean Aquafarms



Hex Box Norway Design

Main Particulars:

Significant wave height:	10 m
Circumference:	250 m
Volume:	433.300 m ³
Capacity salmon:	10.140 mT
Depth of net from MSL:	90 m
Living Quarters:	3-6 persons
Lightship Weight:	6.000 mT
Fish Feed Storage Capacity:	1.000 mT
Power Generation:	Gen. set & windmills
Mooring:	Fixed point mooring

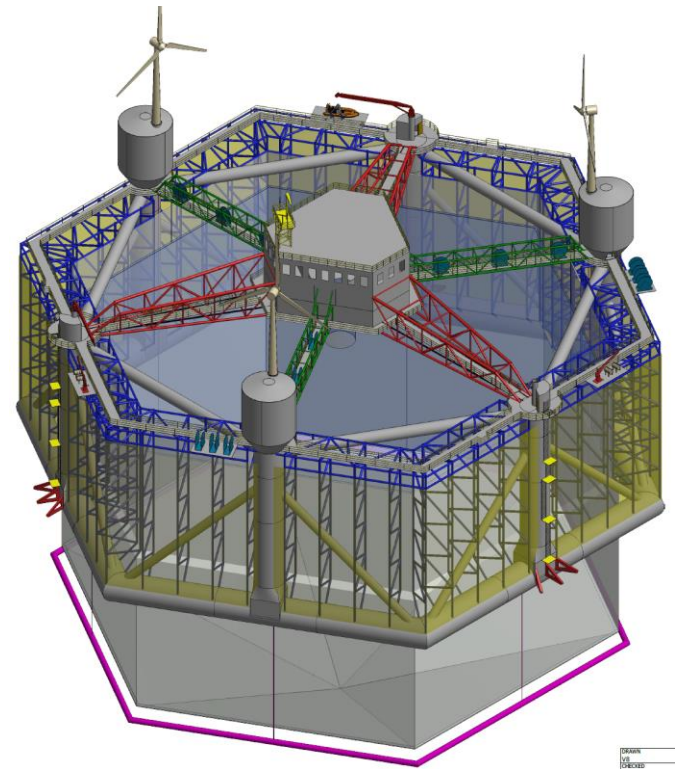

The design can be scaled up or down to be used for different fish types and locations

Project Development Success in China



- ☐ **The Owner of Ocean Aquafarms** has a **good track-record** of initiating projects and constructing projects in China.
- ☐ These include OffRig, Maracc, North Sea Rigs, Beacon Holdings Group, COSL and Landmark Drilling.
- ☐ More than **USD 4 bn worth of projects** have been developed.
- ☐ More than **USD 2 bn worth of the projects** has been Norwegian content

From Rigs to Fish

Safety Issues Hybrid Power Automation



Ballasting Mooring Regulations

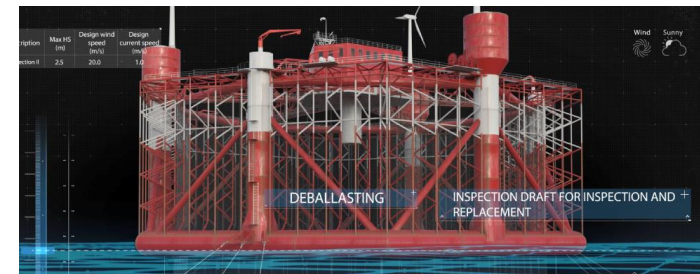

Market Potential

70% of the Earth's surface is covered by water, only 6,5% of the protein sources for human consumption is produced in this element.

Main suppliers

CIMC

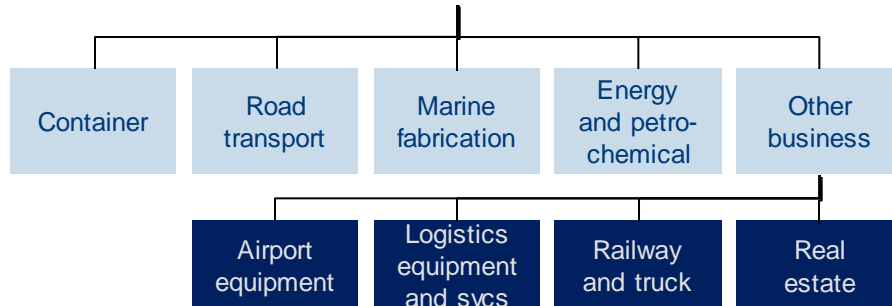

*~63,000 employees across
China, North America, Asia
and Australia*

CIMC is a strong Partner

- Industrialized container manufacture
- Industrialized airport equipment
- Industrialized railway and truck manufacture
- Strong marine fabrication expertise
- Logistics and other services



KONGSBERG

Kongsberg is a key supplier

- Best in class for marine systems
- Strong R & D development
- Aquaculture is a key business segment
- Long term relationship

Main suppliers



BREMNES SEASHORE

*Supplier of salmon
to the entire global
value chain*

Whole fish



- 28 production facilities in nine municipalities
- 21 commercial licenses and 3 R&D licenses
- Manages ~17 k mt biomass
- Reception, slaughter, packing and sale

Smolt



- Three onshore facilities
- Modern production with strong environmental focus
- Production of 1 kg smolt, ~5 mt/year
- RAS technology
- High degree of fish welfare

Refined salmon



- Production of filets and loins for the global market
- Strong focus on quality and top-of-the-line hygiene standard
- Renowned global brands

How to Industrialize a product

Mass production of the Hex Box Solutions:

- Partner with a company that has done it before
- Design and build an optimal cage for the future which is scalable
- Ensure that the design can be easily constructed by using standard products and working with the fabricator during the whole detail design phase
- Use the latest technology and make the design easy to upgrade
- Make the design transportable
- Incorporate automation and renewable energy

A Win – Win solution China/Norway – Example salmon

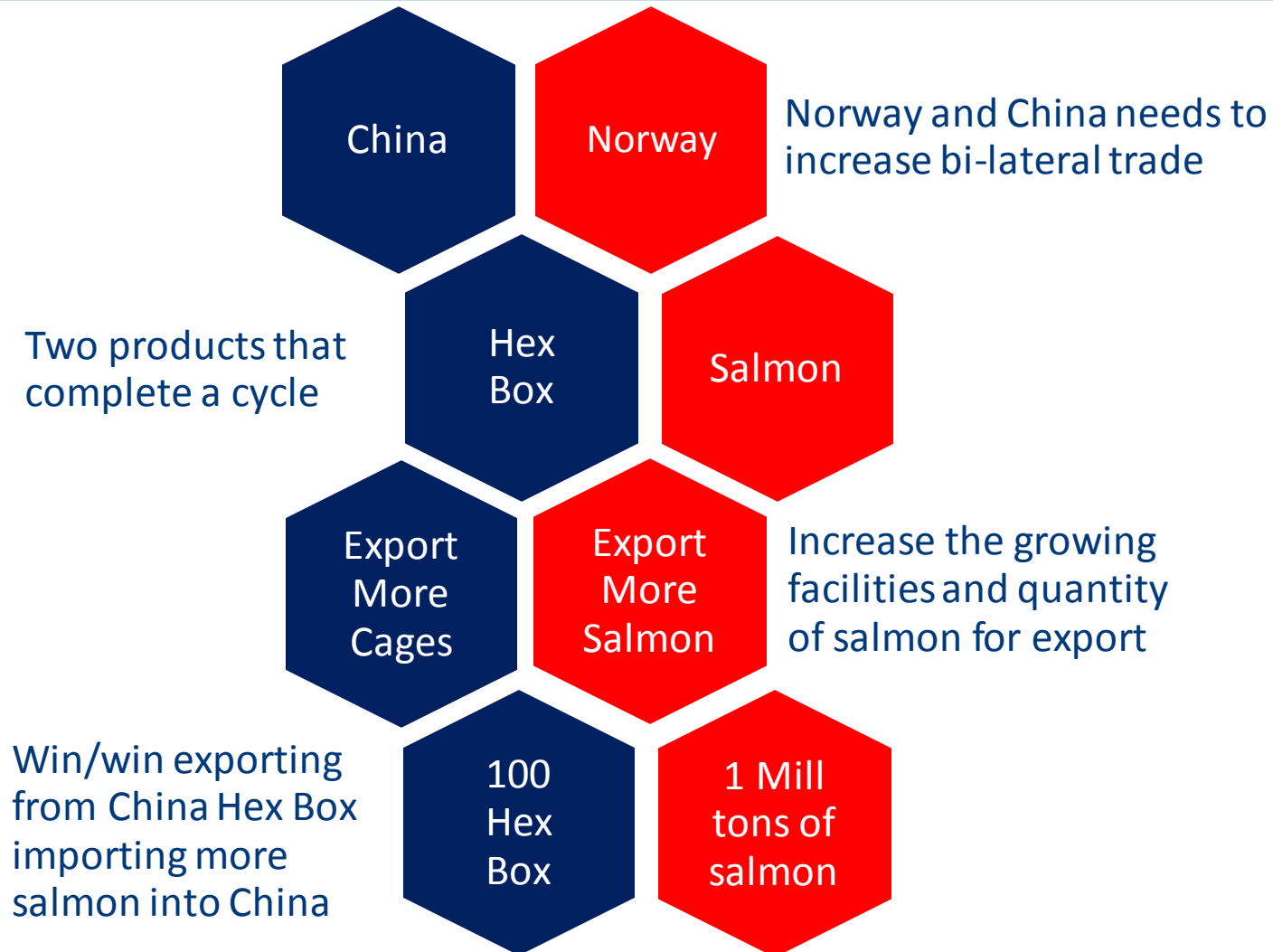

Cooperation has already started

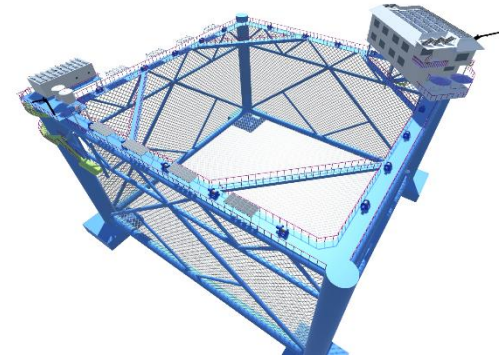
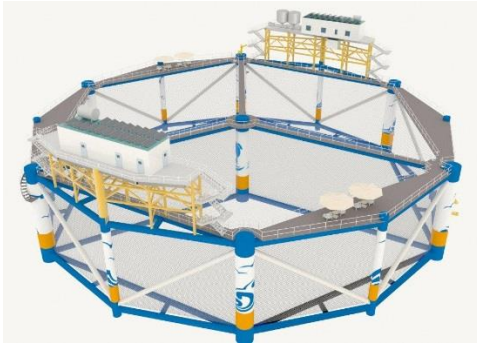

- CIMC Raffles and Ocean Aquafarms AS has established close cooperation in the aquaculture field. CIMC Raffles will perform the basic design, detailed design and production design of the Hex Box.
- They have developed two types of the fish farms suitable for the Chinese sea condition and the local fish farming.

The Ocean Space Future – combines fishing/leisure/tourism

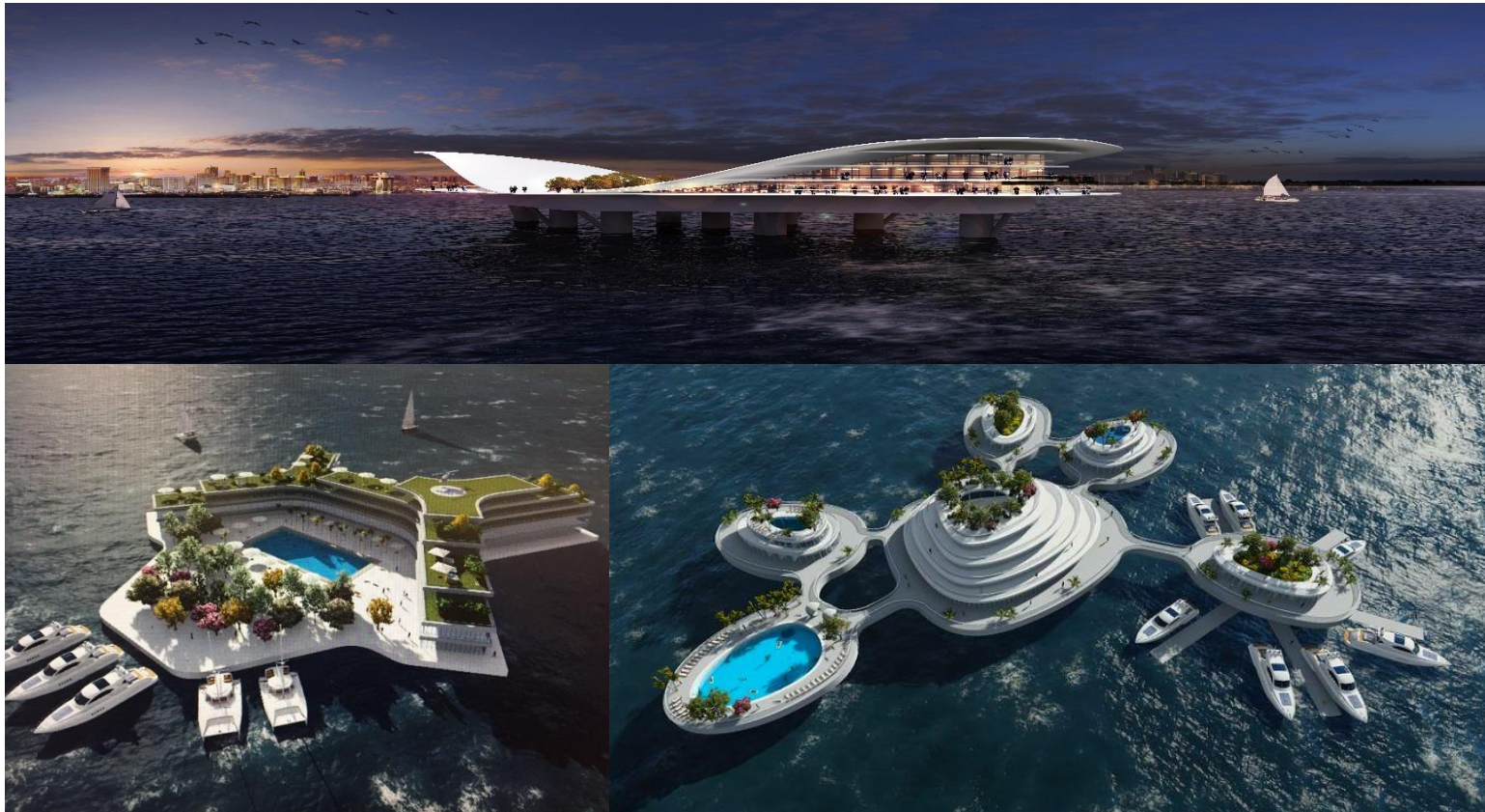

The purpose of large offshore structures is to provide marine leisure, fishing and sea experience tourism opportunities. These facilities could provide dining, accommodation, travel, shopping, entertainment options and other functions.

www.oceanaquafarms.com